

Since 1995, we focus on switches

DB-14 系列电源插座

Rating:

15A 250V AC T105  Approval

10A 250V AC  Approval

Insulation resistance: 100MΩ(min)500V DC

Dielectric withstand voltage: 2500V AC 5s Between terminals

DB-14-2F+
RS601 SERIES

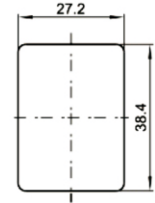
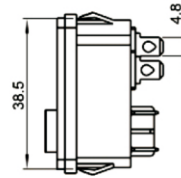
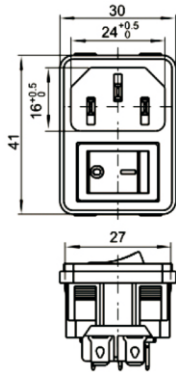
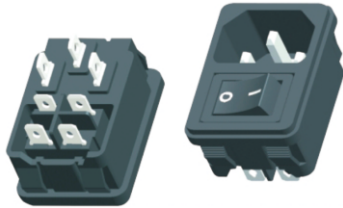

PANEL CUT-OUT

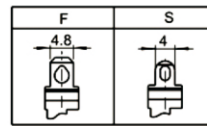

DB-14-2P-DD+
RS601D SERIES

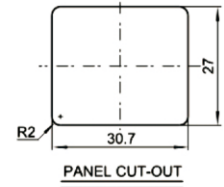
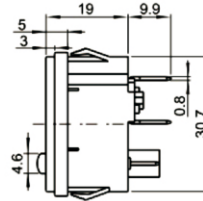
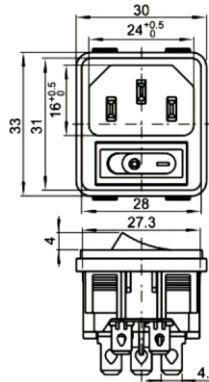
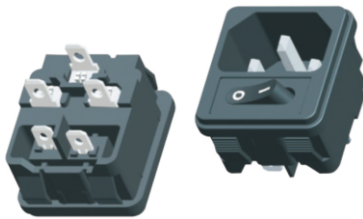

PANEL CUT-OUT

DB-14-5F+
RS601 SERIES

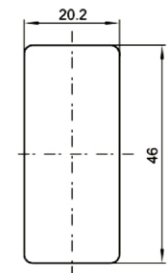
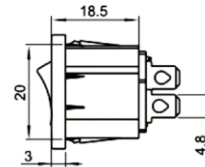
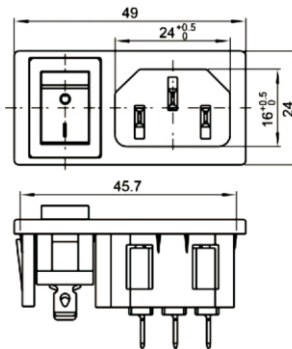
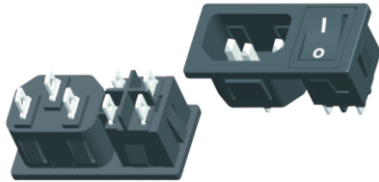

PANEL CUT-OUT

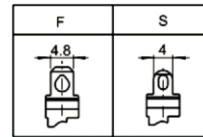

DB-14-3PRS

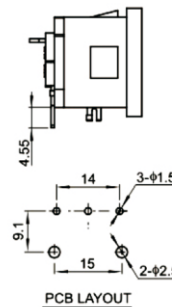
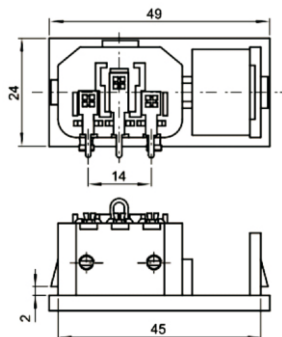
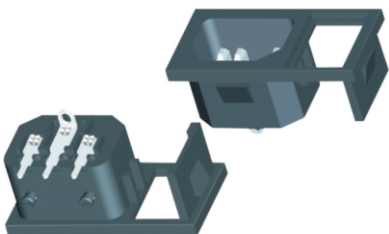

PCB LAYOUT

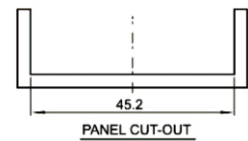

PANEL CUT-OUT

To provide a safe and reliable on-off service, let electric appliances more perfect