

Since 1995, we focus on switches

WS7型防水開關系列 Waterproof switch series

◆ 特點和用途 Characteristics and usage

- 產品結構簡單可靠，防塵、防水。
Simple and reliable product structure, dustproof and waterproof.
- 可配備各種導線
Provide with variety kinds of wires.
- 可在建築物門窗控制裝置、工業控制設備中使用。
Can be used in door and window control devices of building and in industrial control equipments.



◆ 技術特性 Technical Characteristics

項目 Item		特性值 Value
環境溫度 Environment temperature		-40 ~ +85°C
相對濕度 Relative humidity		95%, 40°C
額定值 Ratings		10(4)A 250VAC _μ , 10GPA 125/250VAC _μ , 4A 30VDC 1/2hp 250VAC _μ
動作力 Operating force		≤2N
工作速度 Operating speed		0.1mm ~ 1m/s (無動臂時no lever)
工作頻率 Operating Frequency		機械 60次/min; 電氣 25次/min Mechanical 60 cycles/min; electrical 25cycles/min
絕緣電阻 Insulation resistance		≥100MΩ (500VDC)
接觸電阻 Contact resistance		端子型Terminal type ≤50mΩ 導線型wire type ≤100mΩ
耐電壓 Test voltage	同極不相接端子間 Between terminals of the same polarity	AC1000V, 50/60Hz, 1min
	帶電金屬零件與地(外殼)之間、接線端與不帶電金屬件之間 Between current-carrying metal parts and ground(case), and between each terminal and non-current-carrying metal parts.	AC1500V, 50/60Hz, 1min
抗振動 Vibration resistance		10 ~ 55Hz, 1.5mm雙振幅double amplitude
抗衝擊 Shock resistance		耐久endurance: 1000m/s ² (約100G approx.100G)max 誤動作Wrong action: 300m/s ² (約30G approx.30G)max
防觸電保護等級 Electric shock proof protection grade		I 級 I class
外殼防護等級 Degrees of protection provided by enclosure		IEC IP67
壽命 life		機械 ≥1,000,000次 Mechanical ≥1,000,000 cycles 電氣 ≥10,000次 Electrical ≥10,000 cycles

微動開關系列
MICRO SWITCH SERIES

KW3A

KW4A

KW4A(S)

KW10

MS1

MS2

MS3

MS5

MS10

防水開關系列
WATERPROOF SWITCH SERIES

WS1

WS1L

WS2

WS3

WS4

WS5

WS6

WS7

電源開關系列
POWER SWITCH SERIES

KDC-A11

KDC-A04

PS4

PS5

PS6

RS1

RS2

RS3

其他開關系列
OTHER SWITCH SERIES

SP02

KXZ2

PRS1

◆ 型號規格命名及含義 Model number legend and meanings

WS7 - □ □ □ □ - □
1 2 3 4 5

微動開關系列 MICRO SWITCH SERIES	
KW3A	
KW4A	
KW4A(S)	
KW10	
MS1	
MS2	
MS3	
MS5	
MS10	
防水開關系列 WATERPROOF SWITCH SERIES	
WS1	
WS1L	
WS2	
WS3	
WS4	
WS5	
WS6	
WS7	
電源開關系列 POWER SWITCH SERIES	
KDC-A11	
KDC-A04	
PS4	
PS5	
PS6	
RS1	
RS2	
RS3	
其他開關系列 OTHER SWITCH SERIES	
SP02	
KXZ2	
PRS1	

1 接觸形式 Circuit	Z:轉換式SPDT T:常開(按通)式SPST-NO D:常閉(按斷)式SPST-NC (見說明圖See illustration)	
2 外形特徵 (導線出線方向) Shape characteristics (wire direction)	L: 左方導線Left side wire R: 右方導線Right side wire D: 底面導線Bottom wire type	
3 導線規格 Wire specifications	A:灰色護套綠白電纜Gray jacket with green and white wires 2X0.75mm 300V -40~+90°C B:灰色護套綠白電纜Gray jacket with green and white wires 2X1.0mm 300V -40~+90°C □:其它規格 Other specifications	
4 導線長度 Wire length	用毫米數表示 Indicate with number- "mm"	5 附加規格代號及導線顏色配置代號 Append specs code and wire color code 適用於apply to: 1) 當開關使用了非標準零件如非標準端子時; When used not standard parts such as not standard terminal. 2) 當顧客有特殊動作特性值或其它要求時; When customer has particular operating value or other requirements. 3) 當導線顏色不是默認的配置顏色時。When the wire color is not the default color. ■ 附加規格代號用兩位阿拉伯數字表示, 如01、02、03……在沒有附加規格編號時, 該位置空缺。 Additional spec number shows as 01, 02, 03……If there is no additional numbers, the place is vacant. ■ 導線顏色配置代號: 用三個英文字母按COM、NC、NO順序表示; 若是常開式或常閉式開關, 空缺位置用字母O表示。(顏色代號: 紅-R、白-W、黑-B、綠-G、藍-L、黃-M、灰-H、紫-P)。 Wire color code: indicate with 3 letters, the order is COM、NC、NO; If NO or NC, vacant place shows O. (Color code: red-R, white-W, black-B, green-G, blue-L, yellow-Y, grey-H, purple-P) 示例example: BWR, BOR, RWO ■ 若同時有附加規格代號和導線顏色配置代號, 則導線顏色配置代號位于附加規格代號之後。If there are append specs code and wire color code at the same time, then the wire color code should be after the append specs code. 示例example: 02BWR ■ 導線型開關的引線顏色默認配置規定如下: 公共端引線COM: 黑色 常閉端引線NC: 藍色 常開端引線NO: 白色

Since 1995, we focus on switches

◆ 內部構造圖 Internal configuration drawing

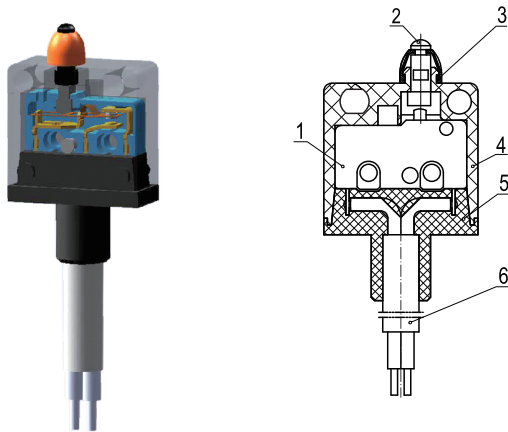

- 1: KW4A微動開關 KW4A Micro switch
- 2: 按鈕 Plunger
- 3: 密封圈 Hermetic loop
- 4: 外殼 Case
- 5: 熱熔膠 Hot melt adhesive
- 6: 護套線 Sheathed wire

◆ 接觸形式說明圖 Circuit illustration

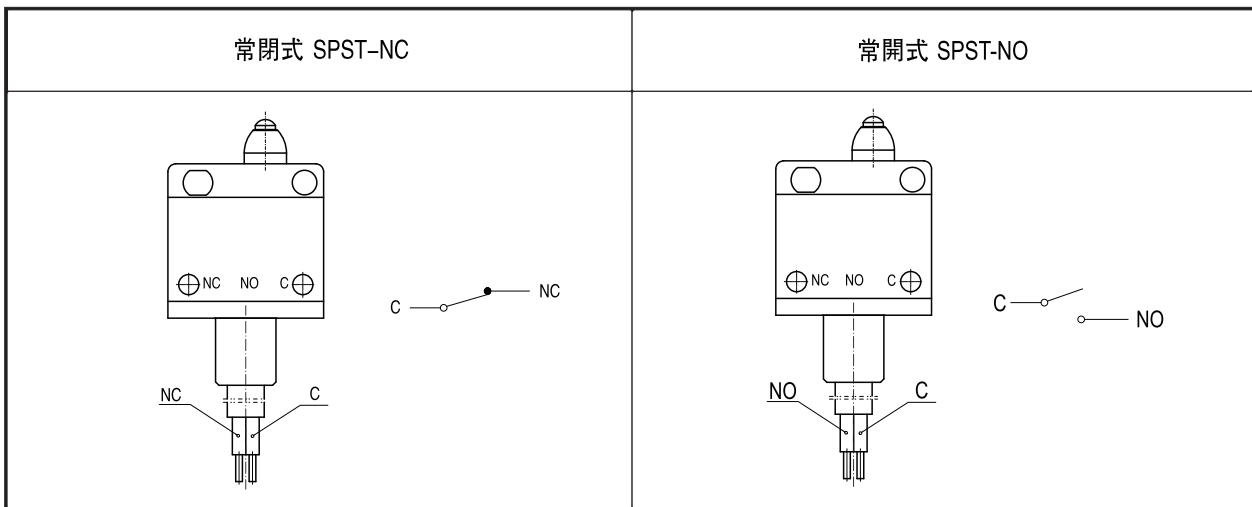

◆ 安裝孔尺寸 Mounting hole dimension

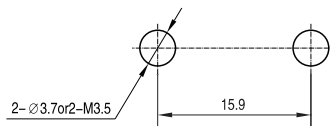

◆ 外形尺寸和動作特性 Dimensions and operating characteristics

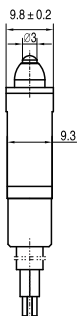
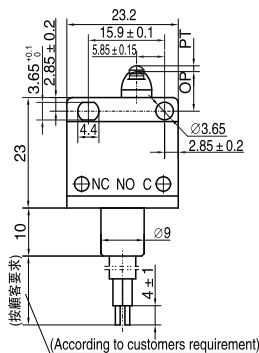

OF Max(N)	2.00
RF Min(N)	0.50
PT Max(mm)	0.8
OT Min(mm)	0.8
MD Max(mm)	0.2
OP (mm)	8.4 ± 0.5

微動開關系列
MICRO SWITCH SERIES

KW3A

KW4A

KW4A(S)

KW10

MS1

MS2

MS3

MS5

MS10

防水開關系列
WATERPROOF SWITCH SERIES

WS1

WS1L

WS2

WS3

WS4

WS5

WS6

WS7

電源開關系列
POWER SWITCH SERIES

KDC-A11

KDC-A04

PS4

PS5

PS6

RS1

RS2

RS3

其他開關系列
OTHER SWITCH SERIES

SP02

KXZ2

PRS1